



CONFERENCE PROGRAM



MACURISA 2014

OCTOBER
22ND, 23RD, 24TH



RESORTS CASINO HOTEL
ATLANTIC CITY, NEW JERSEY



THE MID-ATLANTIC CHAPTER OF URISA'S
17TH REGIONAL GIS CONFERENCE

MAC URISA 2014 CONFERENCE AT A GLANCE

WEDNESDAY OCTOBER 22, 2014

Pre Conference Workshops	Full Day Workshops GIS and Surveying: A Conversation , <i>Producers Room, 13th Level</i> Advanced LiDAR Analysis for Emergency Response , <i>Directors Room, 13th Level</i>
(choose one full day or two half day classes)	Half Day Workshops Introduction to Google Maps Engine, Basic Session , <i>Starlight Room, 1st Level</i> Introduction to Google Maps Engine, Advanced Session , <i>Starlight Room, 1st Level</i> Leveraging the Power of your ArcGIS Online Subscription , <i>Horizon Room, Dining Level</i>

THURSDAY OCTOBER 23, 2014

7:00 AM - 1:30 PM	Registration Desk Open					
8:00 AM - 9:00 AM	Breakfast - <i>Exhibit Hall, Dining Level</i>					
9:00 AM - 10:00 AM	Welcome and Keynote Address <i>Exhibit Hall, Dining Level</i>					
10:00 AM - 10:30 AM	Morning Break - <i>Exhibit Hall, Dining Level</i>					
10:30 AM - 12:00 PM	Transportation <i>Screening Room 13th Level</i>	Coordinates <i>Directors Room 13th Level</i>	Flood Mapping <i>Green Room 13th Level</i>	Data Collection <i>Producers Room 13th Level</i>	Techspo <i>Horizon Room Dining Level</i>	Esri Hands On Learning Lab <i>Starlight Room 1st Level</i>
12:00 PM - 1:30 PM	Lunch - <i>Exhibit Hall, Dining Level</i>					
1:30 PM - 3:00 PM	Transportation <i>Screening Room 13th Level</i>	GIS & Surveying <i>Directors Room 13th Level</i>	Flood Mapping <i>Green Room 13th Level</i>	Planning <i>Producers Room 13th Level</i>	Techspo <i>Horizon Room Dining Level</i>	
3:00 PM - 3:30 PM	Dessert Break - <i>Exhibit Hall, Dining Level</i>					
3:30 PM - 5:00 PM	Public Safety <i>Screening Room 13th Level</i>	LOI Submissions <i>Directors Room 13th Level</i>		Cadastral Mgt. <i>Producers Room 13th Level</i>	Techspo <i>Horizon Room Dining Level</i>	
5:00 PM - 5:45 PM	Lightning Talks <i>Screening Room, 13th Level</i>					
6:00 PM - 9:00 PM	Networking Banquet <i>Exhibit Hall, Dining Level</i>					

FRIDAY OCTOBER 24, 2014

8:00 AM - 11:00 AM	Registration Desk Open						
8:00 AM - 9:00 AM	Breakfast - <i>Exhibit Hall, Dining Level</i>						
9:00 AM - 10:30 AM	Data <i>Screening Room 13th Level</i>	Environmental <i>Directors Room 13th Level</i>	Mobile LiDAR <i>Green Room 13th Level</i>	Emergency Mgt. <i>Producers Room 13th Level</i>	Esri Hands On Learning Lab		
10:30 AM - 11:00 AM	Break - <i>Exhibit Hall, Dining Level</i>						<i>Starlight Room 1st Level</i>
11:00 AM - 12:30 PM	Data <i>Screening Room 13th Level</i>	Remote Sensing <i>Directors Room 13th Level</i>	Tax Maps <i>Green Room 13th Level</i>	Emergency Mgt. <i>Producers Room 13th Level</i>			
12:30 PM - 1:30 PM	Lunch - <i>Exhibit Hall, Dining Level</i>						
2:00 PM - 4:00 PM	New Jersey Geospatial Forum Fall Quarterly Meeting <i>Screening Room, 13th Level (open to the public)</i>						

WELCOME TO MAC URISA'S 17TH REGIONAL CONFERENCE!

Welcome!

On behalf of the Mid-Atlantic Chapter of URISA and the 2014 Conference Planning Committee, it is our pleasure to welcome you to the MAC URISA 2014 Conference at Resorts in Atlantic City, New Jersey.

Our goal for this, our 17th regional GIS conference, is to provide you with exceptional opportunities for you to learn, network, and achieve continuing education credits in your discipline. We have created an exciting multi-day conference format which includes workshops, technical sessions, technology exposition, and learning laboratory.

We invite you to visit our Exhibit Hall which features some of the premier geospatial technology and services available today. Our event would not be possible without our exhibitors and sponsors. We would like to recognize and thank all our sponsors, especially our Premier Sponsors: Esri, Google, Civil Solutions, and Michael Baker. We appreciate the support of all of our exhibitors.

We thank you for choosing to attend our conference and aim to provide you with a comprehensive learning experience. In this regard, we have partnered with the American Planning Association, the New Jersey Board of Licensed Architects, and NJSPLS to pursue accreditation of our technical sessions to support your continuing education needs. As always, attendance at MAC URISA 2014 will also earn GISCI Certification points.

Building on the success of the 2012 conference, we are happy to again host the public quarterly meeting of the New Jersey Geospatial Forum at the end of our conference.

To start this conference, we have selected Andrew Turner as our Keynote Speaker. Andrew is CTO of the Esri R&D Center in Washington, DC and will be speaking on "Seeing the Invisible".

As you look over the details of the program we think you will recognize that our conference offers a rewarding opportunity for professional growth. This could not be achieved without the hard work and dedication of our conference committee and supporters whose commitment to upholding our mission is unmatched.

Enjoy the conference!

Sincerely,



Tom Rafferty
President
Conference Co-Chair

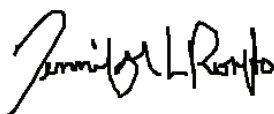

Jennifer (Rovito) Whytlaw
Conference Co-Chair

TABLE OF CONTENTS

Conference At-A-Glance	2	Premier Sponsors	8
Table of Contents	3	Wednesday, Pre-Conference Workshops	9
MAC URISA Leadership	4	Thursday Program	11
Keynote Speaker	5	Friday Program	16
Conference Highlights	6	Exhibitor Listing	18
Conference Committee	7	Resorts map/floor plan	back cover

MAC URISA LEADERSHIP

PRESIDENT

Tom Rafferty
New Jersey Office of Emergency Management

VICE PRESIDENT

Dawn McCall, GISP
Princeton University

PAST-PRESIDENT

Paul Caris, GISP
New Jersey Department of Environmental Protection

SECRETARY

Kathryn McSorley, GISP
Bergen County Department of Health Services

TREASURER

Seth Hackman, GISP
New Jersey Department of Environmental Protection

TRUSTEES

Deirdre Benjamin
Community College of Philadelphia

Dom Elefante
New Jersey Meadowlands Commission

Tom Godish
Sales Executive

John Reiser, GISP
Rowan University

Tom Tiner, GISP
Michael Baker Corporation

Merrilee Torres, GISP
Burlington County Department
of Information Technology

BOARD ELECTIONS

Following this conference, MAC URISA will hold its annual election of half of the Chapter's board members. The following MAC URISA members will be up for election at the close of this conference. Please be sure to look for an email detailing the election procedure and vote in our online voting system. Candidate biographies will be posted on our website for your review. We welcome and look forward to our new Board!

President

Tom Tiner, GISP
Michael Baker International

Secretary

Deirdre Benjamin
Community College of Philadelphia

Trustees

- Dom Elefante, NJ Meadowlands Commission
- Kiersten Gauntt, Burlington County IT
- David Kunz, Civil Solutions, a division of ARH
- Trish Long, USDA NRCS
- John Reiser, Rowan University
- Matt Soslow, Camden County DPW

At the conclusion of the election, the term of service for Paul Caris, Katy McSorley, and Tom Rafferty will conclude. We thank them for their dedication and service to MAC URISA and anticipate many more years of continued involvement.

WHAT IS MAC URISA?

MAC URISA is a volunteer organization with a longstanding reputation for providing quality educational programs to the GIS community. The mission of the Mid-Atlantic Chapter of the Urban & Regional Information Systems Association (MAC URISA) is to:

- Provide a community to facilitate communication & education among the various GIS constituency groups within the Mid-Atlantic region;
- Promote the business of GIS by providing access to networking, new information and technology;
- Foster relationships with organizations with similar missions to further the profession of GIS.

For more information, visit www.macurisa.org



KEYNOTE SPEAKER

ANDREW TURNER

Chief Technology Officer
Esri R&D Center, Washington DC

Andrew Turner is the Chief Technology Officer of the Esri R&D Center in Washington, DC developing new technology for open data sharing and geospatial web collaboration. Originally an aerospace engineer designing autonomous learning spacecraft control algorithms, Andrew became passionate about utilizing making advanced geospatial technology available to everyone for personal analysis and storytelling. He is a member the Open-Source Geospatial Foundation, the OpenStreetMap foundation, and is also the co-founder of Crisiscommons, a global community of technology volunteers that support humanitarian assistant in disasters. Andrew is the author of "Introduction to Neogeography" and "Trends in Where2.0".

Andrew received his B.S in Aerospace Engineering and Computer Science from the University of Virginia and his Masters from Virginia Tech.

Andrew blogs at highearthorbit.com and you can follow him on Twitter @ajturner.

KEYNOTE ADDRESS

"SEEING THE INVISIBLE"

We develop maps that measure and portray our world. This includes the topography, built infrastructure, and often socio-demographic indicators. But what else can our maps tell us about the places we live, move, and work? Location has become a common moniker of people with the rise of geo-enabled smartphones. How can we as an industry leverage this familiarity and excitement to engage to address the important problems of our time?

Keynote address is Thursday, 9AM in the Exhibit Hall.

A SPECIAL THANK YOU

We would like to recognize the following Premier Sponsors of MAC URISA 2014.



Esri is the world leader in the geographic information systems (GIS) software industry. Visit us at www.esri.com.



Offering both a platform solution and professional application, Google Maps Engine enables a full spectrum of maps creation. Learn more and decide which edition is right for you.



Civil Solutions
a division of *arh*

Civil Solutions' fundamental objective is to provide high-end geographic information systems (GIS) and related technology services through innovative problem solving and cost effective solutions.

Michael Baker

INTERNATIONAL

Michael Baker, Jr International Inc. is a national leader in implementing complex enterprise geospatial information technology (GIT) solutions and applying advanced mapping systems for public and private sector clients including telecommunications, pipelines and transportation.

CONFERENCE HIGHLIGHTS

POSTER AND MAP HALL

Ballroom Pre-Function Area, Dining Level

Posters are a great way to share your projects and experience with others and a wonderful opportunity to get ideas for improving your own maps. Make sure to set aside some time to spend in the Poster and Map Hall. All attendees are invited to bring and register a map or poster for the contest. Prizes will be awarded for the best maps/posters at the conclusion of the conference. Please stop by the registration booth for details on how to register your map.

EXHIBIT HALL

*Ballroom, Dining Level
Thursday, 8:00 AM – 3:30 PM
Friday, 8:00 AM – 1:30 PM*

Our Exhibit Hall will afford you the opportunity to explore current services and products that can enhance your GIS. Come see what's new and collect information that will answer your questions so that you can make better purchasing decisions. For more exhibitor information, go to Page 18.

EXHIBIT HALL NETWORKING BANQUET

Thursday, 6:00 – 9:00 PM

Relax and enjoy a social hour and dinner with the company of your colleagues as you visit the Exhibit Hall after a day of learning. Catch up with old friends and network with exhibitors in this stress-free environment. Don't miss this opportunity to share your experiences and unwind with colleagues and the region's top GIS technology vendors!

TECHSPO SHOWCASE

Horizon Room, 1st Level

The Techspo is composed of two components: informal, interactive, scheduled demonstrations and presentations and ongoing table displays that are available for attendees to peruse throughout the conference days.

Techspo presentations are informal and much less structured than a paper presentation. At scheduled times, each presenter will give a 15 minute demonstration, summary of their project, or give a brief introduction and then field questions. The focus of Techspo is on providing attendees an opportunity to interact with the presenters and their displays. This format is especially conducive to demonstrating a process, technique or website.

ESRI HANDS-ON LEARNING LAB SESSIONS

Starlight Room, 1st Level

Take Esri training at your own pace in the Hands-on Learning Lab (HOLL). Come in when you can, no advance registration is required. The HOLL consists of a group of laptops with headphones where students can work through lessons at their own pace.

A lesson consists of a recorded presentation followed by a hands-on exercise. Each lesson typically takes about 45 minutes to one hour to complete and students can generally come and go as they please.

Lessons offered at the ArcGIS Desktop 10.2 HOLL include (subject to change):

1. Introduction to ArcGIS for Desktop
2. Creating a map in ArcGIS for Desktop
3. Basics of the geodatabase model
4. Editing with ArcGIS for Desktop
5. Introduction to versioned editing
6. Editing & maintaining parcel data in a parcel fabric
7. Geocoding with ArcGIS for Desktop
8. Introduction to ArcGIS Network Analyst
9. Introduction to linear referencing
10. Using geometric networks for utilities applications
11. Introduction to ArcGIS Spatial Analyst
12. Introduction to ArcGIS for Server
13. Designing web applications using ArcGIS for Server
14. Sharing maps and tools using ArcGIS Online
15. Sharing data with the Community Maps Program
16. Spatial statistics for public health
17. Working with CAD in ArcGIS for Desktop
18. Introduction to geoprocessing using Python
19. What's new in ArcGIS for Desktop

CONFERENCE COMMITTEE

CONFERENCE CHAIRS

Tom Rafferty, NJ Office of Emergency Management,
Conference Co-Chair

Jennifer (Rovito) Whytlaw, GISP, Rutgers University
Conference Co-Chair

PROGRAM

Dom Elefante, New Jersey Meadowlands Commission,
Team Leader

Kathryn McSorley, GISP, Bergen County Department of
Health Services

Paul Caris, GISP, New Jersey Department of
Environmental Protection

Jennifer Angell, CDMSmith

WORKSHOPS

Trish Long, US Natural Resources Conservation Service
Team Leader

TECHSPO

Merrilee Torres, GISP, Burlington County GIS,
Team Leader

Dan Constanza, Burlington County GIS

Matt Lashendock, Burlington County GIS

POSTERS

Deirdre Benjamin, Community College of Philadelphia,
Coordinator

EXHIBITORS

Tom Godish,
Team Leader

Dawn McCall, GISP, Princeton University

REGISTRATION

Tom Tiner, GISP, Michael Baker International,
Team Leader

PUBLICITY

John Reiser, Rowan University,
Team Leader

Christopher McClain, Brick Township MUA

VENUE

Matt Duffy, GISP, Atlantic County Planning Department
Team Leader

Saiful Alam, Atlantic County Planning Department

Sarah Taylor-Deak, Atlantic County Planning Department

Barry Hackett, Atlantic County Planning Department

VOLUNTEERS

Kiersten Gauntt, GISP, Burlington County GIS,
Coordinator

FINANCE

Seth Hackman, GISP, New Jersey Department of
Environmental Protection,
Treasurer



The Association For **GIS Professionals**
www.URISA.org

URISA 2014-15 CONFERENCES & EVENTS

URISA's 2014 Caribbean GIS Conference
October 26 – 30 2014
Porta Blancu, Nieuwpoort, Curaçao

GIS/CAMA Technologies Conference
March 2-5, 2015
Oklahoma City, Oklahoma

PREMIER SPONSORS

MAC URISA would like to thank the following premier sponsors for their support and contributions to our organization.



Civil Solutions
a division of **arh**

850 S White Horse Pike
PO Box 579
Hammonton, NJ 08037
P: 800-924-0482
<http://www.arh-us.com>

Civil Solutions is a progressive GIS firm versed in data development, custom "service oriented" application programming including ArcPad and ArcGIS Server. Our organization offers a host of GIS services including parcel, utility and tax mapping; ArcIMS data hosting; GIS software customization; consultation and implementation services. We have provided services for over one hundred agencies distributed among federal, state, county and municipal organizations. Our experience and innovation provide cost effective solutions for both small and large clientele. Leverage our experience to implement an innovative solution to create your geographic switchboard.

Michael Baker

INTERNATIONAL

American Metro Boulevard
Hamilton, NJ 08619
P: 609-807-9575
<http://www.mbakerial.com>

Baker is a national leader in implementing complex enterprise geospatial information technology (GIT) solutions and applying advanced mapping systems for public and private sector clients including telecommunications, pipelines and transportation. With more than 60 years of expertise, Baker has mapped millions of square miles of the earth's surface while supporting engineering and construction, water resources and environmental programs. More recently, Baker has expanded its capability through an innovative Aerial and Mobile LiDAR (Light Detection and Ranging) systems that accurately determines range, elevation, and other critical mapping data. With hundreds of GIS, survey, mapping and IT professionals in Geospatial Service Centers across North America, Baker is a GIT powerhouse of experience and resources.



1400 Morris Drive, Suite 102
Chesterbrook, PA 19087
P: 610-644-3374
<http://www.esri.com>

With annual sales of more than \$660 million, ESRI has been the world leader in the geographic information system (GIS) software industry for more than 30 years. As the leader in GIS technology, ESRI offers innovative solutions that will help you create, visualize, analyze, and present information better and more clearly. Working with location information, ESRI's GIS software and solutions give you the power to solve problems you encounter every day. Organizations around the world, as well as local, state, and federal government agencies, are using ESRI GIS software to make smart and timely decisions. ESRI provides powerful GIS solutions to more than 300,000 clients in more than 150 countries. In fact, ESRI is leading the industry in providing mapping technology that meets today's global needs. ESRI offers GIS solutions to help you unlock the spatial component of your valuable data and see your organization's information from a new perspective.



Google
1600 Amphitheatre Parkway
Mountain View, CA 94043
650-253-0000
<http://www.google.com/enterprise/mapsearch>

Google Maps Engine is changing the way enterprises create and use maps - replacing complex GIS technologies with accurate and comprehensive Google Maps-based tools. Create maps intuitively using Google Maps' easy-to-use and familiar technology. With compatibility across Google products, such as Google search, Google Earth and the more than 1M maps being powered by the Google Maps API, your maps can be discovered by the world.

WEDNESDAY OVERVIEW

7:00 AM – 1:00 PM	Registration
7:30 AM – 8:30 AM	Breakfast
8:30 AM – 5:00 PM	Workshops
12:00 PM – 1:00 PM	Buffet Lunch
5:30 PM – 6:30 PM	MAC URISA Board Meeting

Did you know?

You can earn GISCI Education Certification points for attending a pre-conference workshop and the conference!

PRE-CONFERENCE WORKSHOPS

Wednesday, October 22, 2014

8:30 AM – 5:00 PM

GIS AND SURVEYING: A CONVERSATION

Producers Room, 13th Level

Instructors: F. Peirce Eichelberger, gDBMS, Inc.

Peter Borbas, Borbas Surveying & Mapping, LLC

Intended Audience: GIS and Surveying professionals.

The 2004 Surveyor of the Year together with a Past President of URISA International discuss how the fields of GIS and Surveying can utilize the best practices of both disciplines. The goal of this full day workshop is to give GIS folks a much greater appreciation for the surveyor's role in GIS and to give surveyors a broader perspective of all things GIS.

Some of the topics to be covered include:

- Horizontal and vertical control, datum shifts
- CAD and GIS undefined why metadata is more important than ever
- GPS undefined what's the difference between surveying and just finding things
- Legal descriptions undefined where they come from, who makes 'em, who needs 'em?
- As-builts, what about the "Z"?

ADVANCED LiDAR ANALYSIS FOR EMERGENCY RESPONSE

Directors Room, 13th Level

Instructor: Mike Umansky, Applied Imagery

Intended Audience: Anyone with an interest in learning about and exploring LiDAR data should attend.

LiDAR is a proven technology with many applications and is widely available in the Mid-Atlantic Region. Recent domestic events and natural disasters have brought to the forefront the need to utilize elevation data in more time-sensitive, tactical ways. This full day workshop's focus is to briefly introduce basic LiDAR concepts and terminology, and then to offer hands-on training in Quick Terrain Modeler focusing on emergency response and preemptive disaster planning. Data used during the hands on portion of the workshop will include multiple areas impacted by natural events, including landslide data in the Pacific Northwest and Superstorm Sandy data from the New Jersey coast.

Topics Covered:

- LiDAR Basics Briefing
- Visualization of LiDAR
- Data Fusion (Orthos, Vector Data, etc)
- Data Analysis (Line of Sight, Flood Simulation, QA, AGL, Slope, Contours, etc)
- Data Sharing & Export



INTRODUCTION TO GOOGLE MAPS ENGINE

Starlight Room, 1st Level

Instructor: Sean Wohltman, Google

Intended Audience:

- Morning Session: Introductory workshop to orient users to this platform
- Afternoon Session: Advanced workshop geared towards developers

Come learn how to upload, visualize, and share your geospatial on the extraordinarily scalable geospatial platform from Google, Google Maps Engine. In this session you will get familiar with the Google Maps Engine platform and work all the way through publishing a map of your own data to Google's servers around the world where you can share it with the world, or just trusted colleagues and customers.

You will also learn about the Google Maps Engine API and learn how you can easily upload and sync data from your own custom application, or qGIS, ArcGIS, and Safe FME.

As a prerequisite, please make sure you have a Google Apps or gmail account and that you join this Google Group with that account before the workshop:

<https://groups.google.com/forum/#!forum/mac-urisa-gme>

This will be used to give you access to Google Maps Engine for the workshop.

LEVERAGING THE POWER OF YOUR GIS ONLINE

SUBSCRIPTION

Horizon Room, 1st Level

*Instructors: Jake Skinner, Esri
Lauri Dafner, Esri*

Intended Audience: Anyone who is interested in learning about this technology should attend.

An ArcGIS Online Subscription is an integral component of your Esri platform. Attendees of this half day workshop will participate in hands-on exercises to create and share useful information products. Live demonstrations may be used to augment the material. Participants will log into an ArcGIS Online Subscription and have the chance to experience many of the various roles encountered by users of an online subscription. Web maps will be created and styled with symbology, thematic classes, and informational popups. Attendees will explore ArcGIS online Analysis tools, editing workflows, and the use of application templates.

POSTER AND MAP CONTEST

Don't forget to stop by the Poster and Map Gallery and vote for your favorite submission!



THURSDAY OVERVIEW

7:00 AM – 10:30 AM	Conference Registration Desk Hours
8:00 AM – 3:30 PM	Exhibit Hall Hours
8:00 AM – 9:00 AM	Breakfast in Exhibit Hall
9:00 AM – 10:00 AM	Welcome and Keynote Address
10:00 AM – 10:30 AM	Break in Exhibit Hall
10:30 AM – 5:00 PM	Esri Hands-on Learning Lab
10:30 AM – 12:00 PM	Educational Sessions & Techspo
12:00 PM – 1:30 PM	Lunch in Exhibit Hall
1:30 – 3:00 PM	Educational Sessions & Techspo
3:00 – 3:30 PM	Dessert Break in Exhibit Hall
3:30 – 5:00 PM	Educational Sessions and Techspo
5:00 – 5:45 PM	Lightning Talks
6:00 – 9:00 PM	Exhibit Hall Networking Banquet

THURSDAY 9:00AM - 10:00AM

WELCOME AND KEYNOTE ADDRESS

Room: Exhibit Hall, Dining Level

Gather at 9:00 for the Opening Ceremony. The Conference Committee will welcome attendees to Resorts Atlantic City and note some of the highlights of this year's conference.

Keynote Address

"Seeing the Invisible"

Andrew Turner, CTO

Esri R&D Center, Washington, DC



THURSDAY 10:30AM - 12:00PM

TRANSPORTATION

Screening Room, 13th Level

Even though we work in a digital medium paper maps are still the most popular way to convey spatial data. This session will cover how to use model builder, collector, and execution instructions to automate this process and complete it quickly within ArcMap. Atlantic County GIS staff will provide the challenges faced in producing a county wide atlas while Jason Kreyling will explain similar issues in how to successfully manage the public information maps at all NJ Transit rail and light rail stations.

• **Development of the Atlantic County Atlas**

Saiful Alam, GISP, Matthew Duffy, GISP, Barry Hackett, & Sarah Taylor-Deak, GISP, Atlantic County Government (45 minute session)

• **An Overview of NJ Transit's Public Information**

Display Inventory Program

Jason Kreyling, Michael Baker Jr. Inc.

GIS & SURVEYING: COORDINATES

Directors Room, 13th Level

Geodesy is key to producing maps that are spatially accurate. In GIS most of the geodetic data are derived from Global Navigation Satellite Systems (GNSS) whereas most of the traditional surveying data are derived from ground based monuments. These presentations will key on the differences between both systems and how to accurately move between both system.

• **Geodesy for GIS**

Dr. John Miima, New Jersey Institute of Technology

• **NAD83 Coordinate System and Adjustments**

Dr. John Miima, New Jersey Institute of Technology

• **Ground versus Grid: It Really Matters**

Dr. John Miima, New Jersey Institute of Technology

FLOOD MAPPING

Green Room, 13th Level

The last time we met at our conference was literally days before Hurricane Sandy impacted our region with record flooding. Our presenters in this session detail the flood risk studies conducted since Sandy and showcase

models that can be used to identify the flood risk in your neighborhood.

- **Flood Vulnerability Assessment Map for Little Ferry, Moonachie, Carlstadt, and South Hackensack**

Stephanie Bosits, New Jersey Meadowlands Commission

- **GIS-Based Tools for Quantifying and Communicating Flood Risk**

Kunal Patel, NJ Dept. of Environmental Protection, Bureau of Dam Safety & Flood Control

- **NJADAPT - Flood Exposure Platform**

Jennifer Rovito, GISP, Rutgers University, Bloustein School of Planning and Public Policy

DATA COLLECTION AND INTEGRATION

Producers Room, 13th Level

Most of us have gone into the field for data collection in one form or another. By doing so we are exposing ourselves to many types of hazards. Learn how to work outside and minimize placing yourself at risk for injury. As a bonus, learn about GLIS, The Geographic and Land Information Society and its continuing mission to educate GISers and Surveyors about what each other does and promote interaction among the disciplines.

- **GIS Field Work and Lyme Disease**

J. Peter Borbas, PLS, PP, Borbas Surveying and Mapping, LLC

- **GLIS and How You Can Get Involved**

J. Peter Borbas, PLS, PP, Borbas Surveying and Mapping, LLC

- **GIS Field work and Safety**

J. Peter Borbas, PLS, PP, Borbas Surveying and Mapping, LLC

TECHSPO

Horizon Room, Dining Level

Ongoing table displays are available for you to peruse throughout the day. Interactive demonstrations scheduled for this session include:

- **From Data to TA-DA! – Delivery of Interactive GIS Data Quick, Simple & Free (well mostly)**

Janel Bisacquino, Mercer County Department of Transportation and Infrastructure

- **300 Years of Municipal Boundary Changes**

Patricia Leidner, GISP, Hunterdon County Division of Geographic Information Systems

- **Working with Pop-ups in ArcGIS Online Web Maps**

Merrilee Torres, GISP, Burlington County Dept. of Information Technology

THURSDAY 12:00PM - 1:30PM

BUFFET LUNCH

Exhibit Hall

All registrants are invited to partake of a buffet luncheon in the Exhibit Hall. This is a great opportunity to network with your peers as well as visit the exhibit hall, poster displays or Techspo tables.

THURSDAY 1:30PM - 3:00PM

TRANSPORTATION

Screening Room, 13th Level

Transportation department are facing more requirements to manage infrastructure and assets. The topics of this session are geared towards automating those requirements and the lessons learned here can be applied to other disciplines which rely on automated mapping and asset management systems.

- **Improving Off-System Road Management using Local Governments**

Bruce Aquila, Intergraph

- **Streamlining and Lowering the Cost of Stormwater Inspection at Mississippi DOT**

Bruce Aquila, Intergraph

- **HPMS 2010 Database Maintenance Application & Functional Class Review**

Kevin McElwain, Michael Baker Jr. Inc.



GIS & SURVEYING

Directors Room, 13th Level

Sharing information between GIS and CAD can range from simple to complex so it is important to know your data, know your software and know your limitations. This session will discuss three methods of sharing GIS data with CAD users and also cover how to do an adjustment on a boundary in ArcGIS.

- **Using GIS Data in AutoCAD**

William DiBartolo, PLS, County of Morris

- **Exporting Useful GIS Data from CAD**

William DiBartolo, PLS, County of Morris

- **Survey Adjustments on a Boundary in ArcGIS**

Dr. John Miima, New Jersey Institute of Technology

FLOOD MAPPING

Green Room, 13th Level

Want to better understand the role GIS plays in floodplain management? Experts from the NJDEP are on hand to orient you to the role of flood plain managers and how they use the latest technology to protect lives and property from flooding.

- **Which Flood Elevations Matter to You**

Wendy Lathrop, PLS, CFM, NJ Dept. of Environmental Protection, Green Acres Program

- **Blue Acres Floodplain Acquisitions**

Wendy Lathrop, PLS, CFM, NJ Dept. of Environmental Protection, Green Acres Program

- **Certified Flood Plain Managers: What Do They Do?**

A. Chris Gould, CFM & Joseph Ruggeri, PE, CFM, NJ Dept. of Environmental Protection, Bureau of Dam Safety & Flood Control

PLANNING

Producers Room, 13th Level

GIS has its origins in planning. Come hear how these planners are using GIS today to help government officials, business leaders, and citizens create communities that offer better choices for where and how people work and live.

- **The Use of ArcGIS Online for Local Planning Boards - The Virtual Site Visit**

David Kunz, GISP, Civil Solutions, a division of ARH

- **Modernizing Election Services with GIS**

Jim Girvan, GISP & Jerry Midgette Esq., Somerset County

- **Implementing ArcGIS Online & Template Applications in Local Communities**

Calen Daugherty, Civil Solutions, a division of ARH

TECHSPO

Horizon Room, Dining Level

Ongoing table displays are available for you to peruse throughout the day. Interactive demonstrations scheduled for this session include:

- **Magic for Data Management - a Trick for Renaming Files**

Janel Bisacquino, Mercer County Department of Transportation and Infrastructure

- **ArcGIS Keyboard and Mouse Shortcuts**

Christopher Nagy, Mercer County

- **Tips for Working with Excel Data in ArcGIS Desktop**

Merrilee Torres, GISP, Burlington County Dept. of Information Technology

THURSDAY 3:00PM - 3:30PM

DESSERT BREAK

Exhibit Hall

Enjoy some light refreshments before the final educational sessions of the day.



GIS & SURVEYING: LETTER OF INTERPRETATION (LOI)

Directors Room, 13th Level

The NJDEP Division of Land Use Regulation issues a Letter of Interpretation (LOI) to provide or confirm information about the presence or absence, boundaries, and/or resource value classification of freshwater wetlands, transition areas, and/or State open waters. This session will provide an overview of the NJDEP electronic LOI Application and Digital Data Standards, review the process for submitting an electronic LOI Application and answer questions about the new digital submission process.

- **LOI Submissions Standards**

William DiBartolo, PLS, County of Morris & Lou Jacoby, NJ Dept. of Environmental Protection

- **LOI Process for Submissions**

William DiBartolo, PLS, County of Morris & Lou Jacoby, NJ Dept. of Environmental Protection

- **Get your Questions Answered about New LOI Submissions**

William DiBartolo, PLS, County of Morris & Lou Jacoby, NJ Dept. of Environmental Protection

PUBLIC SAFETY

Screening Room, 13th Level

Learn how Alabama has used GIS in developing their school safety plans. These plans map the placement of 81 different elements, such as evacuation routes and hazardous materials, into a visualization tool. Schools, colleges, universities can update their plans easily and education personnel, first responders, and key partners have the ability to utilize the safety planning tool in variety of ways that better protects the schools of Alabama.

- **Using GIS Technology for Safe Schools**

Lamar Davis, SICS Consultants, LLC

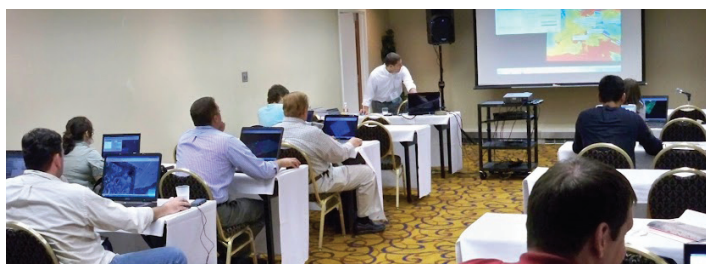

CADAstral MANAGEMENT

Producers Room, 13th Level

Property records management has been an ongoing issue for GIS since the first parcel map was created. These presentations detail how to get around the common roadblocks of managing these data on a state, regional, and municipal level.

- **Challenges in Joining Building Footprints to Parcel Data**

A. Chris Gould, NJ Dept. of Environmental Protection, Bureau of Dam Safety & Flood Control

- **Mobile Improving City Property Management in Virginia Beach**

Bruce Aquila, Intergraph

- **Integrating GIS into a Permit Workflow**

David Wisniewski, New Jersey Meadowlands Commission

TECHSPO

Horizon Room, Dining Level

Ongoing table displays are available for you to peruse throughout the day. Interactive demonstrations scheduled for this session include:

- **Using Esri Maps for Office and Spatial Analyst for Cluster Mapping**

Matthew Lashendock, GISP, Burlington County Dept. of Information Technology

- **Burlington County Guide Rail Inventory**

Patrick Kane, Taylor Wiseman & Taylor

- **Doing More with SQL**

John Reiser, GISP, Rowan University

BE SOCIAL!

Share your photos and thoughts on the conference by including #macurisa2014 in your posts!

LIGHTNING TALKS

Screening Room, 13th Level

This session is full of quick-fire presentations guaranteed to get your GIS creativity flowing. Presentations cover a wide range of core geospatial applications for local government and communities. Hone your skills with some cartography and mobile GIS insights and enjoy the energy of this fast moving session.

- **Ready-to-use Services for Maps, Geocoding, Routing & More**

Jake Skinner, Esri

- **Getting Data Under Control: Mapping & Exploiting Imagery and Point Clouds**

Wayne Byrd, Intergraph

- **Best Practices for Stormwater Inspections Using ArcGIS Online**

Bob Pliszka, GISP, JMT Technology Group

- **Making a Great First Impression: Customizing your ArcGIS Online Home Page**

Lauri Dafner, Esri

- **Redistricting of New Jersey Lions - Part 2**

Sarah Taylor-Deak, GISP, Atlantic County Government

- **Resolving Conflicts with GIS Tracking**

Kavitha Maddula, CDM Smith

EXHIBIT HALL NETWORKING BANQUET

This event will provide you with an opportunity to meet and discuss the topics of the day with other GIS professionals while enjoying a buffet dinner. The evening will include a networking cocktail reception and prizes for the Poster Contest will be awarded. You won't want to miss it!



HANDS-ON LEARNING LAB

Don't forget to stop in on the Hands-On Learning Lab in the Starlight Room on the 1st Level. No need to make an appointment!



FRIDAY OVERVIEW

8:00 AM – 11:00 AM	Conference Registration Desk Hours
8:00 AM – 1:30 PM	Exhibit Hall Hours
8:00 AM – 9:00 AM	Breakfast in Exhibit Hall
8:00 AM – 2:00 PM	Esri Hands-on Learning Lab
9:00 AM – 10:30 AM	Educational Sessions
10:30 AM – 11:00 AM	Break in Exhibit Hall
11:00 AM -12:30 PM	Educational Sessions
12:30 PM – 1:30 PM	Lunch in Exhibit Hall
2:00 PM – 4:00 PM	New Jersey Geospatial Forum Fall Quarterly Meeting (open to the public)

FRIDAY 9:00AM - 10:30AM

DATA COLLECTION AND INTEGRATION

Screening Room, 13th Level

Open data are out there waiting to be integrated with online mapping solutions. In this session you will learn how to get started using online GIS applications along with how to tap into open data and tools which will enable your geospatial systems to better utilize the cloud.

- **Getting Started with ArcGIS Online for Orgs**
Chris McClain, Brick Township MUA
- **ArcGIS for Open Data**
Lauri Dafner, Esri
- **Open Data and Tools for Better Spatial Analysis**
Sarah Cordivano, Azavea

GIS & SURVEYING - MOBILE LiDAR

Green Room, 13th Level

Come hear all about Mobile LiDAR. Start by learning the differences between mobile and traditional LiDAR, gain a perspective on the details of data acquisition and ground control, and end with knowing how to identify appropriate and cost-effective applications of this new technology.

- **Mobile LiDAR Basics**
Kurt Lutz, CP, Robinson Aerial Survey
- **Mobile LiDAR Data Acquisition**
Kurt Lutz, CP, Robinson Aerial Survey
- **Application of Mobile LiDAR**
Kurt Lutz, CP, Robinson Aerial Survey

EMERGENCY MANAGEMENT

Producers Room, 13th Level

Two years ago, on the last day of the conference, Sandy officially became a hurricane. The following week the storm impacted our region. For the first time ever, FEMA declared an emergency by using remotely sensed GIS data instead of waiting for field data collection. This session will give you an overview of the emergency management field and how GIS is used during all phases.

- **Enterprise GIS – Supporting the Four Stages of Emergency Management**

F. Peirce Eichelberger, gDBMS, Inc.

ENVIRONMENTAL

Directors Room, 13th Level

Scientists and environmental managers use GIS to study the environment, report on environmental phenomena, and model how the environment is responding to natural and man-made factors in our region and beyond.

- **Short-Term Changes in Vegetation Assemblage Distribution**
Ildiko Pechmann, Ph.D., New Jersey Meadowlands Commission
- **Examination of Arsenic Levels Collected Under NJ's Private Well Testing Act**
Nicholas Procopio, GISP, NJ Dept. of Environmental Protection
- **Trees, Income, & Health in Pittsburgh's Nine Mile Watershed**
Ellie Newman, University of Pittsburgh

FRIDAY 10:30AM - 11:00AM

COFFEE BREAK

Exhibit Hall

Come and enjoy a refreshment break in the exhibit hall.



FRIDAY 11:00AM - 12:30PM

DATA COLLECTION AND INTEGRATION *Screening Room, 13th Level*

Taking advantage data collection by using all the tools available to you to geolocate your data while you are collecting them can save numerous hours in building your GIS. This session will demonstrate some of the best practices towards collecting data effeciently so you can begin your analysis sooner.

- **Working with Geotagged Photos & GIS**
Trish Long, US Natural Resources Conservation Service
- **Gaining the Total View Through Geospatial Technologies**
Richard Rehmann, GISP, Civil Solutions, a division of ARH
- **Simplified Field Data Collection Using ArcGIS**
Jake Skinner, Esri

GIS & SURVEYING - TAX MAPS *Green Room, 13th Level*

The Blue Book is going digital! It has been completely re-written from cover to cover. Here is your chance to get your roadmap to the new bluebook. It is anticipated that Division of Taxation will be releaseing these regs soon. This session will detail the progression from the paper age to the digital age.

- **Update on Tax Map Regulations, Part 1**
Donald Walby, PLS, KS Engineers PC
- **Update on Tax Map Regulations, Part 2**
Lewis Conley, PLS, PP, Van Note - Harvey Associates
- **Digital Tax Map Error Report**
Dawn McCall, GISP, Princeton University

EMERGENCY MANAGEMENT *Producers Room, 13th Level*

Continue the theme of Emergency Management by listening to the experts in this field share case studies on how they use and interpret GIS data to minimize the exposure of risk to lives and property.

- **Better Disaster Preparedness Through GIS**
Alan Leidner, Booz Allen Hamilton
- **Coastal Surge Inundation Mapping on the NJ Turnpike & Garden State Parkway**
Anton Getz, Michael Baker International
- **Mountains of Information: Analyzing Public Safety GIS Data**
Chris Klaube, Monmouth County Sheriff's Office

REMOTE SENSING *Directors Room, 13th Level*

The acquisition and analyzing methods of remote sensing data are rapidly changing. From using balloons and lasers to capture data, to analyzing where effluent flows using models based on field data, this session is designed for those who are interested in modeling large areas.

- **Balloon Imagery for Assessing Wetland Sites**
Sal Kojak, New Jersey Meadowlands Commission
- **The Role of Hydrodynamics and Geomorphology on Sediment Movement in a Fragmented Micro-tidal Estuary: Implications for Coastal Flood Resilience Planning**
Dr. Francisco Artigas & Joe Grzyb, New Jersey Meadowlands Commission
- **Applying GIS to Green Infrastructure Analysis & Design in NYC**
Richard Bartholomew, Arup

FRIDAY 12:30PM - 1:30PM

BUFFET LUNCH *Room: Exhibit Hall*

All registrants are invited to partake of a buffet luncheon in the Exhibit Hall. This is a great opportunity to network with your peers as well as visit with the exhibitors.

FRIDAY 2:00PM - 4:00PM

NEW JERSEY GEOSPATIAL FORUM FALL QUARTERLY MEETING *Screening Room, 13th Level*



The New Jersey Geospatial Forum (NJGF) is an open organization, encouraging the participation of any individual interested in New Jersey's geospatial industry. Membership in the NJGF is open to anyone in the state who shares a common interest in geographic information and technology.

Open to the public.

EXHIBITOR DIRECTORY

APPLIED IMAGERY

5425 Wisconsin Avenue, Suite 600
Chevy Chase, MD 20815
301-589-4446
www.appliedimagery.com

Mike Umansky
mumansky@appliedimagery.com

AXIS GEOSPATIAL

101 Bay Street
Easton, MD 21601
410-882-1441
www.axisgeospatial.com

Allan Blades
ablades@axisgeospatial.com

BAE SYSTEMS

124 Gaither Drive, Suite 100
Mt. Laurel, NJ 08054
856-866-9700
www.baesystems.com

Andy Pickford
andrew.pickford@baesystems.com

CIVIL SOLUTIONS, A DIVISION OF ARH

850 South White Horse Pike
Hammonton, NJ 08037
800-924-0482
www.civilsolutions.biz

Richard Rehmann
rrehm@arh-us.com

ESRI

Chesterbrook Corporate Center
1325 Morris Drive, Suite 201
Chesterbrook, PA 19087
610-644-3374
www.esri.com

Jason Sealy
jsealy@esri.com



GOOGLE

1600 Amphitheatre Parkway
Mountain View, CA 94043
650-253-0000
www.google.com/enterprise/mapsearch

KEYSTONE PRECISION INSTRUMENTS

1670 East Race Street
Allentown, PA 18109
800-833-9250
www.keypre.com

George Allport, Jr.
georgejr@keypre.com

JMT TECHNOLOGY GROUP

47 Loveton Circle, Suite H
Sparks, MD 21152
267-252-9566
www.jmttg.com

Bob Pliszka
bpliszka@jmttg.com

LATITUDE GEOGRAPHICS

200-1117 Wharf Street
Victoria, BC V8W1T7
Canada
888.578.5545
www.latitudegeo.com

Michael Funaro
mmaftei@latitudegeo.com

LIZARDTECH

1008 Western Avenue, Suite 200
Seattle WA 98104
207-869-5279
www.lizardtech.com

Laura Ramage
lramage@lizardtech.com

MICHAEL BAKER INTERNATIONAL

300 American Metro Boulevard, Suite 154
Hamilton, NJ 08619
609-734-7900
www.mbakerial.com

Justin Furch
jfurch@mbakercorp.com

PICTOMETRY

100 Sunday Drive
State College, PA 16801
814-574-7285
www.pictometry.com

Steve Benner
steve.benner@pictometry.com

PROPERTY PILOT

79 Hudson Street, Suite 503
Hoboken, NJ 07016
201-222-1155
www.propertypilot.com

Sandy Lyna
slyna@propertypilot.com

SCANWIDE.COM

673 Potomac Station Drive, #103
Leesburg, VA 20176
703-655-0310
www.scanwide.com

Sean Eikenbery
sales@scanwide.com

SPATIAL DATA LOGIC, INC.

2 Executive Drive, Suite 200
Somerset, NJ 08873
732-357-1299
www.spatialdatalogic.com

Thomas Hurley
sales@spatialdatalogic.com

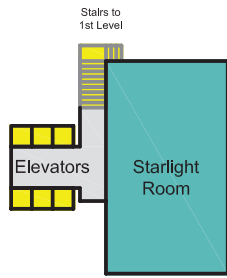

1st Level

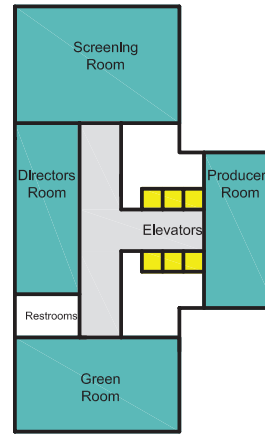

13th Level

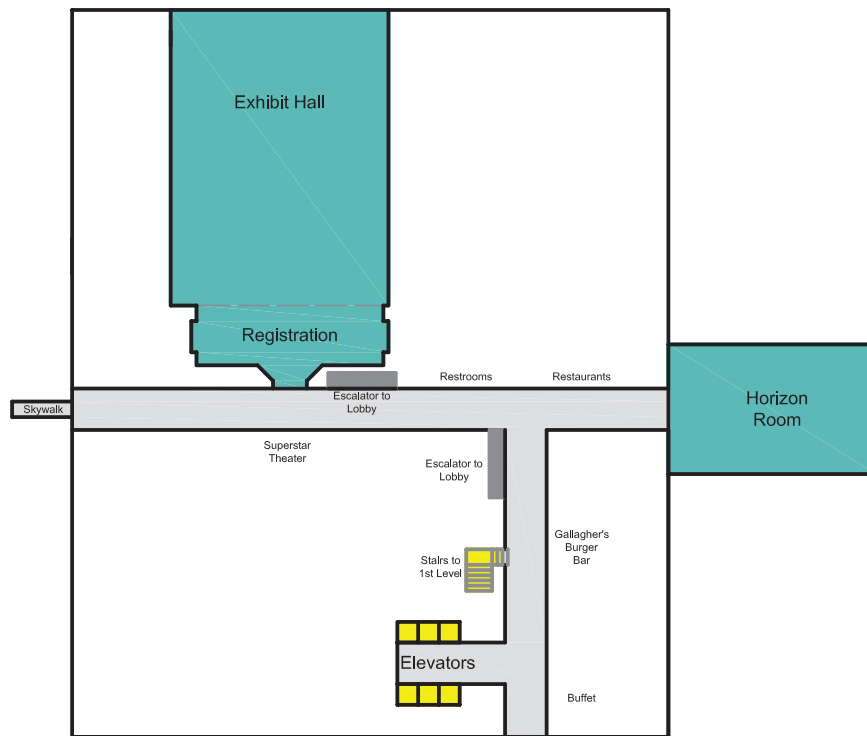

Dining Level



Mid Atlantic Chapter of the
Urban and Regional Information Systems Association
Post Office Box 22233 Trenton, New Jersey 08607

Check www.macurisa.org for information on upcoming events